

Tool Box Cam Lock

This cam lock is designed for tool boxes and various security applications. It features a secure locking mechanism to protect valuable contents.



ADDITIONAL IMAGES



Product Overview



Key-centric electronic access control system designed for high security and zero maintenance.

Intelligent Passive Access Control

This advanced access control system utilizes passive technology, meaning no power, wiring, or maintenance is required for the lock cylinders. Each system integrates unique, non-duplicable smart keys with robust management software to track and control access in real-time. Designed for durability and industrial reliability, the system provides high-security authentication that prevents unauthorized access in diverse professional environments.

Technical Specifications

Operating Environment

-40 °C Min Temperature	70 °C Max Temperature	97 % Max Humidity
----------------------------------	---------------------------------	-----------------------------

IP Rating

IP68

Expected Service Life

10 years

Model Comparison

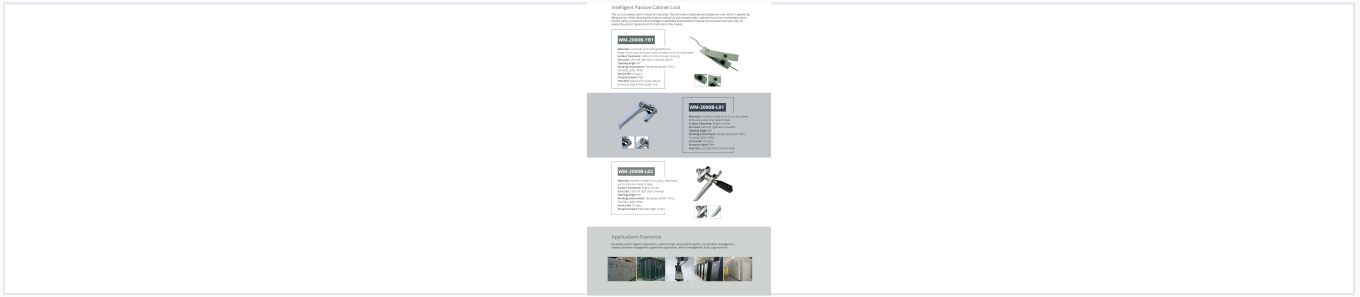

Detailed view of model variations and durable construction features for industrial use.

Model Specifications

Model	Material	Finish
WM-2000B-YB1	Zinc Alloy	Matte Chrome
WM-2000B-L01	No.5 Zinc Alloy	Bright Chrome
WM-2000B-L02	Zinc Alloy	Bright Chrome

Applications

Common Industry Applications

Logistics Supervision, Railway Container Management, Airport Logistics, Customs Smart Card, Bulk Cargo Terminals, Vehicle Management