

# Submersible Sewage Water Pump, 0.75-1.5kW

This submersible sewage pump is designed with a channel impeller to prevent clogging from solids. It is suitable for wastewater discharge in industrial, commercial, and residential applications.



## Overview

### High-Efficiency Submersible Sewage Pump

The B Series is a robust submersible sewage pump featuring a specialized channel impeller designed to prevent internal clogging by solids. Engineered for demanding environments, it handles wastewater, muddy water, and lye across industrial, municipal, and agricultural applications. With a durable cast iron construction and AISI304SS stainless steel shaft, this pump ensures reliable performance in both single and three-phase power configurations.

## Key Performance Metrics

### Performance Highlights

**860 m<sup>3</sup>/h**

Max Capacity

**44 m**

Max Head

**20 m**

Immersion Depth

**1.5 kW**

Max Power

## Technical Specifications

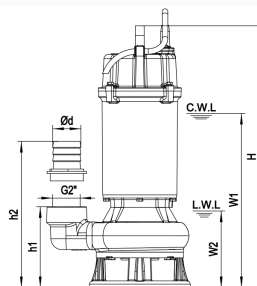

Standardized dimensions and water level requirements for installation planning.

### Insulation Class

Class F

### Protection Rating

IP68

### Operating Limits

- Water temperature: up to 40
- PH Range: 6 - 10
- Liquid Density: 1.3g/cm<sup>3</sup>
- Cable length: 8m

## Materials of Construction

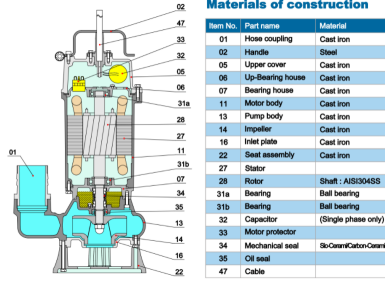

Detailed internal construction showing cast iron components and stainless steel shaft for maximum durability.

## Component Materials

Component	Material
Pump Body & Impeller	Cast Iron
Motor Body & Upper Cover	Cast Iron
Rotor Shaft	AISI304SS Stainless Steel
Mechanical Seal	SiO-Ceramic / Carbon-Ceramic
Handle	Steel

## Applications

### Primary Applications

Industrial Wastewater, Municipal Sewage, Storm-water Drainage, Construction Dewatering, Aquaculture, Treatment Plants

## Model Comparison

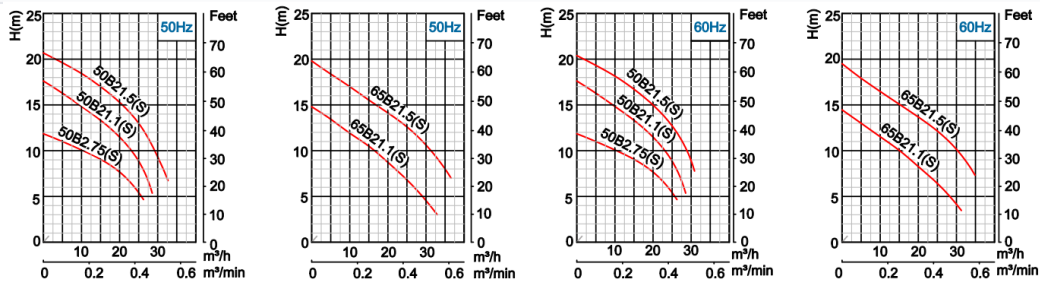

Head vs. Flow rate performance curves for various models in the B Series range.

## Performance by Model (50Hz/60Hz)

Model	Power (kW)	Outlet (mm)	Rated Head (m)	Max Flow (m <sup>3</sup> /h)
50B2.75(S)	0.75	50	10	26
50B21.1(S)	1.1	50	15	29
65B21.1(S)	1.1	65	10	33
50B21.5(S)	1.5	50	19	33
65B21.5(S)	1.5	65	15	37