

Stainless Steel Worm Gear Reducer for IEC Metric Motors

These stainless steel worm gear reducers are designed for IEC metric motors. They offer efficient power transmission and reliable performance in demanding industrial environments.



ADDITIONAL IMAGES



Product Overview



Durable stainless steel housing designed for high-efficiency power transmission.

High-Performance Worm Gear Reducer

This stainless steel worm gear reducer is engineered for IEC metric motors, offering a robust solution for demanding industrial environments. Designed for durability and corrosion resistance, the unit features precision-machined gears that ensure smooth operation, high efficiency, and low noise levels. Its compact, lightweight construction makes it an ideal choice for a variety of power transmission systems requiring reliable, long-term performance.

Key Features

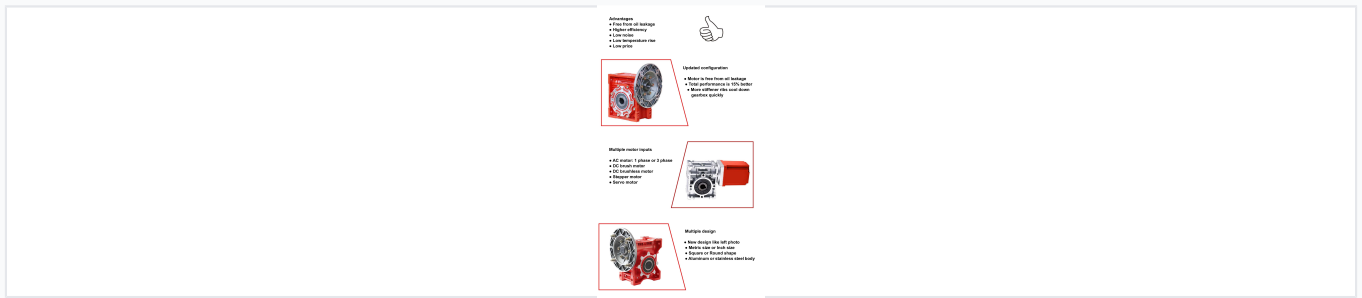

Technical overview highlighting performance improvements and motor compatibility.

Performance Advantages

- Free from oil leakage
- 15% improvement in total performance
- Enhanced cooling via stiffener ribs
- High efficiency and low noise operation
- Corrosion-resistant stainless steel construction
- Low temperature rise during operation

Compatibility

Compatible Motor Types

AC (1-Phase), AC (3-Phase), DC Brush, DC Brushless, Stepper Motor, Servo Motor

Technical Specifications

Design Configurations

Category	Options
Sizing Standard	Metric or Inch
Shape	Square or Round
Material	Aluminum or Stainless Steel