

Soil Moisture Sensor with Alarm

This device detects moisture levels in soil using three probes. When the moisture level falls below a set threshold, the device emits an audible alarm.

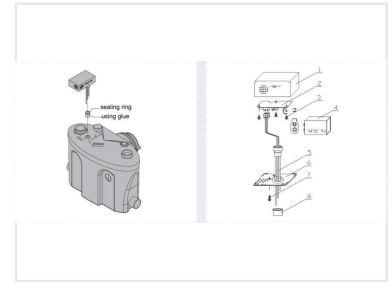

ADDITIONAL IMAGES



Product Overview

Intelligent Moisture Monitoring

This soil moisture sensor is designed to provide critical alerts for wastewater management systems. It features an integrated alarm function that delivers a voice warning when moisture levels indicate that wastewater is not being effectively removed. The device is built for reliability and ease of use, ensuring timely intervention to prevent potential operational issues.

Technical Specifications

Power Supply	6F22 9V Battery
Probe Configuration	3 probes
Assembly Dimension	18 mm

Compatibility

Compatible Systems

- 400 Series
- 400-A Series
- 400-N Series
- 400-S Series

Features

Controls	ON/OFF Switch, Audible Alarm, Voice Warning
----------	---------------------------------------------