

Precision Plumb Bob with 3-Meter String

This precision plumb bob is designed for accurate vertical alignment in various applications. Its solid body is forged with a high-precision mold and includes a 3-meter string for extended reach.



ADDITIONAL IMAGES



Overview

Professional Precision Plumb Bob

This high-precision plumb bob is engineered for accurate vertical alignment in construction, building inspection, and decorating tasks. Featuring a solid forged body made from qualitative carbon steel, it ensures high concentricity and stability even in challenging conditions. The integrated long-reach line and anti-corrosive finish make it a durable and indispensable tool for professional tradesmen.

Design & Construction



Body Construction	One-time forging with high-precision mould for a solid, integral body
Material	Qualitative carbon steel
Surface Treatment	Yellow Painted, Fine Grinding, Anti-corrosive Paint

Precision Features

Alignment Precision	High concentricity design keeps the same level skew to increase vertical measuring accuracy
Centering Mechanism	Yes

Technical Specifications

Weight Options

300g • 400g • 500g

Model Dimensions

Model Code	Weight	Width	Height
1558030	300g	46mm	69mm
1558040	400g	51mm	76.5mm
1558050	500g	56mm	77.5mm

Line & Hanger

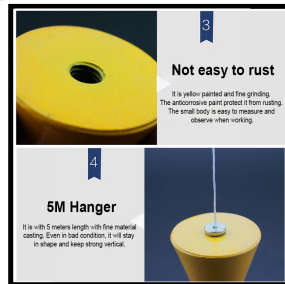

String Length

5 m

Hanger Length

Hanger Quality

Fine material casting that stays in shape and maintains strong verticality in bad conditions

Applications

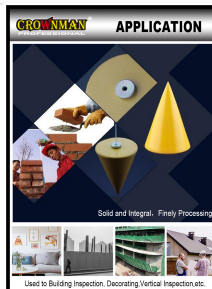

Primary Applications

- Building Inspection
- Interior Decorating
- Vertical Alignment Reference
- Construction Site Measuring