

Portable Single Burner Gas Stove Cooktop

This portable gas stove features a single burner design suitable for camping, outdoor cooking, or small kitchens. It includes a rotary switch for adjusting the flame intensity from simmering to sautéing.

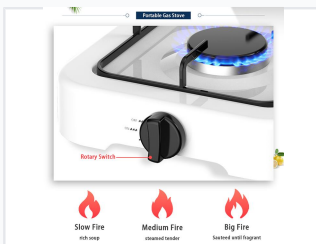

ADDITIONAL IMAGES



Product Overview

Versatile Portable Cooking Solution

This portable single burner gas stove is designed for high-efficiency cooking in diverse environments, ranging from outdoor camping trips to small kitchen setups. It features a robust rotary control system that allows for precise flame intensity, enabling users to manage everything from slow simmering to high-heat sautéing. Engineered for portability and safety, it offers a stable cooking surface and reliable performance for emergency preparedness or casual travel.

Performance Features

Cooking Modes

- Slow Fire (Simmering)
- Medium Fire (Steaming)
- Big Fire (Sautéing)

Control Type

Rotary Switch

Usage & Application

Primary Applications

Camping, Outdoor Cooking, Small Kitchens, Emergency Preparedness

Design

Burner Quantity

1

Portable Design

Yes