

Polycrystalline Silicon Solar Street Light

This solar street light uses new polycrystalline silicon solar panel technology. It has an IP68 waterproof and dustproof rating and features a modern split design with a separate solar panel and lamp body for easy maintenance and replacement.

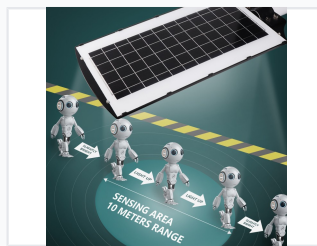

ADDITIONAL IMAGES



Overview

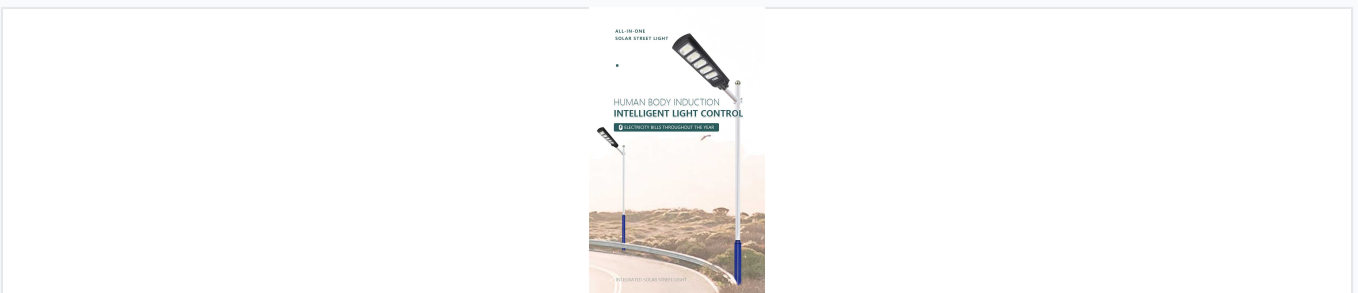

Integrated solar street light design with intelligent control.

High-Efficiency Solar Street Lighting

This polycrystalline silicon solar street light utilizes advanced solar technology and human body induction to provide reliable, energy-efficient outdoor illumination. The system features a modern split design with an integrated solar panel and high-brightness SMD lamp beads, making it easy to install and maintain. Built for durability, it includes an IP66 waterproof rating and intelligent light control, ensuring automatic operation that eliminates electricity bills for pathways, parking lots, and streets.

Technical Specifications



IP66 waterproof design tested in real-world weather conditions.

Performance Highlights

10 m

Sensing Range

6 h

Fast Charging Time

66 IP

Waterproof Rating

Available Model Specs

Model	Power	Battery	Lamp Beads
RZ-50W	6W	5000mAh	48
RZ-100W	10W	10000mAh	96
RZ-150W	12W	15000mAh	144
RZ-300W	19W	20000mAh	240

Features

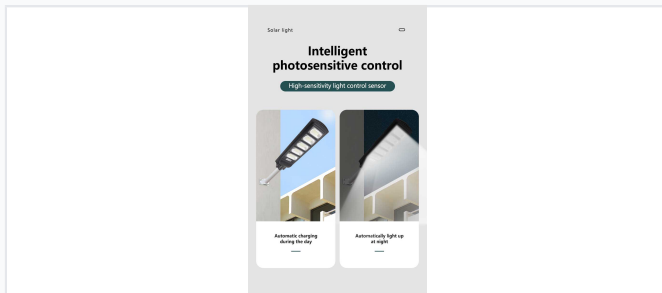

Automatic charging during the day and illumination at night.

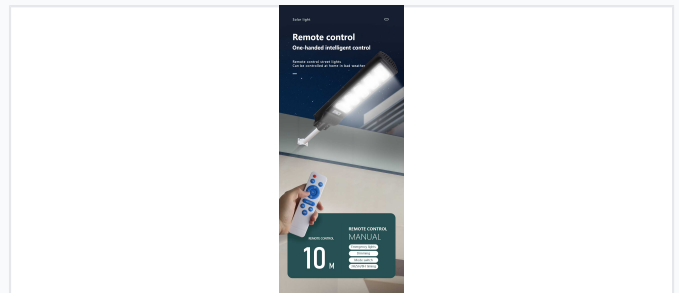

Full control over timing, dimming, and emergency modes.

Why Choose This Light

- Zero electricity bills
- Weatherproof IP66 construction
- Easy maintenance split design
- Radar-based motion detection

Operation Modes

Remote Control, Human Body Induction, Intelligent Light Control, Timer Settings