

# Pillow Block Ball Bearing Unit with Cast Iron Housing

This pillow block ball bearing unit is designed for mounting on surfaces parallel to the shaft axis. It features a cast iron housing, a grease fitting for relubrication, and a standard radial ball bearing insert.

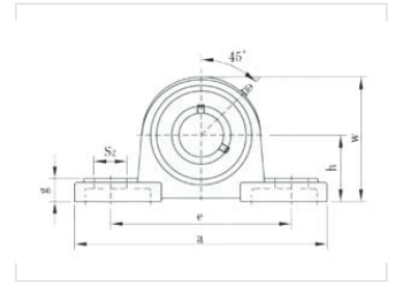

## Product Overview

### Industrial Pillow Block Bearing

This pillow block ball bearing unit is engineered for reliable performance in industrial machinery, featuring a robust cast iron housing designed for mounting on surfaces parallel to the shaft axis. It incorporates a standard radial ball bearing insert and includes a grease fitting to facilitate easy relubrication, ensuring extended service life. Ideal for conveyor systems and agricultural equipment, this unit is built to handle moderate loads and operational speeds effectively.

## Technical Specifications

Housing Material	Cast Iron
Lubrication	Yes
Grease Fitting Angle	45 °
Common Applications	Conveyor Systems, Agricultural Machinery, Industrial Equipment

## Design Features

### Performance Profile

**1 Moderate**  
Load Capacity

**1 Moderate**  
Speed Rating

Mounting Orientation	Parallel to shaft axis
----------------------	------------------------