

# Pillow Block Ball Bearing Unit

This pillow block ball bearing unit is designed for mounting on surfaces parallel to the shaft axis. The unit features a robust housing and a self-aligning bearing insert to accommodate shaft misalignment.

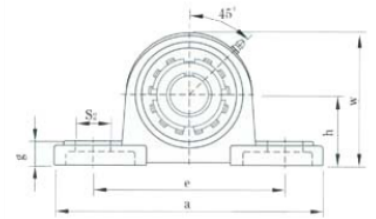

## Product Overview

### UKP200 Series Pillow Block Unit

The UKP200 series pillow block ball bearing unit is engineered for reliable rotational support in industrial applications. Designed for mounting on surfaces parallel to the shaft axis, this unit features a robust housing paired with a self-aligning bearing insert to effectively accommodate shaft misalignment. It is built for ease of installation and maintenance, incorporating a grease fitting positioned at a 45-degree angle for convenient lubrication.

## Technical Specifications

Series	UKP200
Lubrication Fitting	45-degree angle grease fitting
Key Features	Self-aligning, Robust housing, Parallel mounting, Easy installation

## Dimensions

### Key Dimensions

- Overall length (a)
- Base length (e)
- Height (h)
- Bearing width (w)
- Bolt hole spacing (S2)