

# Miniature N20 Geared Motor

This miniature N20 geared motor is designed for applications requiring compact size and quiet operation. It is suitable for use in small fans, intelligent electronic locks, and other precision mechanisms.

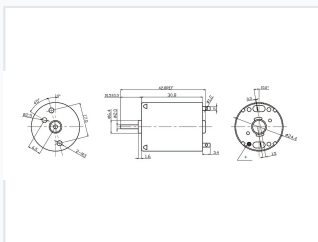

## ADDITIONAL IMAGES



## Product Overview

### Compact Performance

The Miniature N20 Geared Motor is engineered for high-efficiency operation in space-constrained environments. It offers superior reliability, quiet performance, and precise control, making it an ideal component for portable electronics and battery-operated devices. With low current consumption and dynamic response, it provides a dependable solution for modern precision mechanisms.

## Physical Dimensions

### Output Shaft

Dimension	Value
Diameter	2.0 mm
Length	10.5 ± 0.3 mm

### Mounting Specifications

- Front faceplate diameter: 17.0 mm
- Mounting holes: 2-M3 screws
- Auxiliary mounting holes: 2.5 mm diameter, 45° angle, 6.5 mm spacing
- Rear faceplate: 24.4 mm diameter, 0.3 mm thickness
- Mounting tab diameter: 1.2 mm

Motor Body Length	30.8 mm
-------------------	---------

Reference Length	42.8 mm
------------------	---------

## Performance Features

### Key Advantages

Quiet Operation • Low Inertia • Energy Efficient • Low Cogging • Battery Compatible

### Typical Applications

Portable Medical, Smart Electronics, LED Lighting, Hand Tools, Wearables, Personal Hygiene, Cooling Modules