

Mini LED Indicator Light with Red Lamp

This mini LED indicator light features a red lamp for clear signaling. It is designed for use in control panels, machinery, and other industrial equipment.



Overview



High-Performance LED Signaling

The AD22-16DS series represents a modern advancement in indicator technology, utilizing high-brightness LED chips as a long-lasting and low-consumption alternative to traditional incandescent and neon lamps. These compact indicators are designed for high reliability and aesthetic appeal, featuring a durable polycarbonate lampshade with superior anti-surge performance. Engineered for versatility, they are ideal for signaling, forewarning, and accident indication across electrical power, telecommunications, and industrial machinery sectors.

Technical Specifications

Voltage of Working Frequency	2.5kV (AC valid value), 1min
Insulated Resistance	eMI©
Voltage Wave Allowed	±20%
Rated Current	20 mA
Compliance Standards	IEC947-6-1, EN50947-5-1, IEC/EN 60947-5-1



Physical Dimensions



AD22-16DS

Protected
LED
Indicator

24V AC/DC
36V AC/DC
48V AC/DC
110V AC
127V AC
220V AC

-  Red
-  Green/PG
-  Yellow
-  Pure Blue
-  White/PW

AD22-16DS

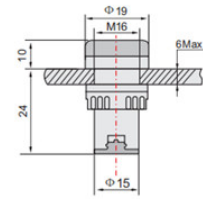

Mounting Specifications

19 mm

Mounting Hole (I)

16 M

Thread Size

6 mm

Max Panel Thickness

24 mm

Total Length

Options & Variants

Available Colors

Red • Green • Yellow • Pure Blue • White

Voltage Options

- 24V AC/DC
- 36V AC/DC
- 48V AC/DC
- 110V AC
- 127V AC
- 220V AC
- 230V AC

Application Areas

Target Industries

Electrical Power, Telecommunication, Machine Tools, Watercraft, Textile, Printing, Mine Machinery

Product Features

Key Benefits

- Long operational life
- Low power consumption
- Small volume and light weight
- High brightness LED source
- Anti-surge polycarbonate lens
- Safe bolt-type connectors