

Electrical Specifications

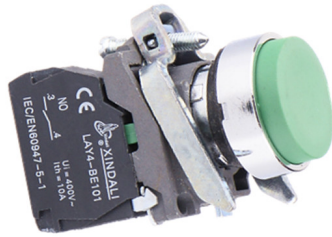

Specializing in production of buttons and indicators since 1997

Robust metal construction with clearly labeled contact terminals.

Rated Insulation Voltage	600 V
Conventional Heating Current	10 A
Insulation Resistance	e50M Ω
Contact Resistance	d25m Ω
PF Withstand Voltage	AC 2.5KV/min

Mechanical & Durability



LAY4-BL42

Projecting
push button
Spring return

N/O



N/C

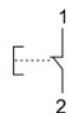

- Black LAY4-BL21
- Green LAY4-BL31
- Blue LAY4-BL61
- Yellow LAY4-BL51
- Red LAY4-BL42

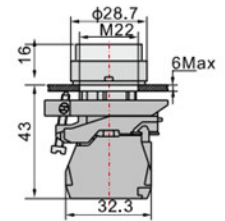

Dimensional specifications including M22 mounting hole and head diameter.

Mechanical Life (Pushbutton)	1000000
Electrical Life (Pushbutton)	5000000
Mounting Hole Diameter	22 mm
Maximum Panel Thickness	6 mm

Compliance & Certifications

Standards Compliance

IEC60947-5-1 • GB/T14048.1

Certifications

CE, ISO9001, RoHS, UL