

# Low Sugar Rice Cooker with Spherical Inner Pot

This low sugar rice cooker has a 1.6L capacity and 500W power. It features a spherical inner pot made of 1.5mm aluminum alloy with a non-stick coating.



## ADDITIONAL IMAGES



## Overview

### Healthy Cooking Solution

This advanced rice cooker is designed for health-conscious consumers, utilizing innovative siphon distillation and starch-separation technology to significantly reduce sugar and starch content in cooked rice. With a compact 1.6L capacity, it is perfect for preparing fresh, portion-controlled meals without waste. The appliance features multiple cooking modes and precise temperature control, ensuring delicious results while supporting healthier dietary habits.

## Performance & Capacity

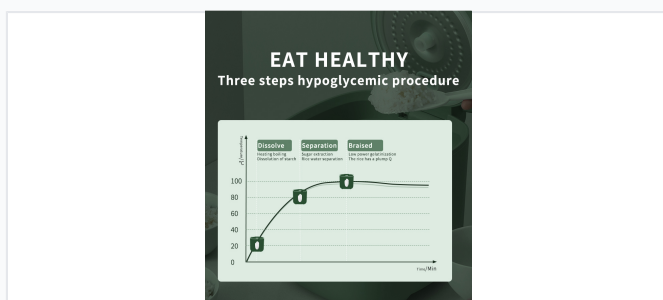

The three-step hypoglycemic procedure: dissolving starch, separating sugar, and low-power braising for optimal texture.

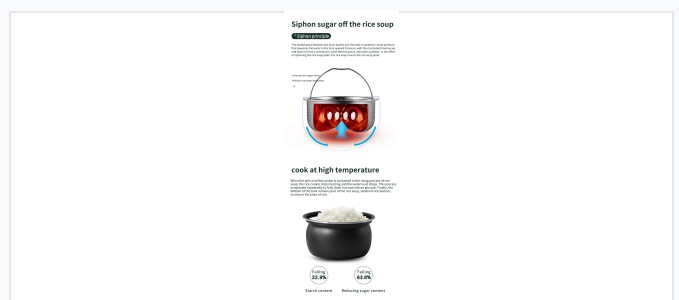

Advanced siphon technology forces water through the rice to extract excess starch and sugars.

### Key Performance Metrics

**500 W**

Power

**1.6 L**

Capacity

**1.5 cups**

Low Sugar Rice Max Capacity

**3 cups**

Normal Rice Max Capacity

## Technical Specifications

### considerate design



Detailed design features including food-grade 304 stainless steel components and intelligent overflow prevention.

## Dimensions & Weight

Item	Dimensions (mm)
Product Size	206 x 192 x 188
Unit Gift Box	285 x 255 x 295
Carton Size (4pcs)	585 x 525 x 320

## Construction Details

- Spherical inner pot design
- 1.5mm aluminum alloy pot
- Non-stick coating
- Food-grade 304 stainless steel sugar extractor

## Approvals & Standards

CB, CE, EMC, LVD, ERP, ROHS, LFGB

## Logistics

Container Loading (20GP/40GP/40HQ)	1200 / 2400 / 2744 pcs
Minimum Order Quantity	2744 pcs

## Accessories

### Product family photo



Complete set including the rice cooker, inner pot, and essential kitchen accessories.

## Included Accessories

Spherical Inner Pot • SUS Rice Container • Water Container • Measuring Cup • Rice Spoon • Power Cord