

Low Pressure Switch for Water and Pneumatic Systems

This low-pressure switch protects water and pneumatic systems by interrupting the electrical connection when pressure decreases. It features a reset button and is designed for use in booster sets and fire-fighting systems.

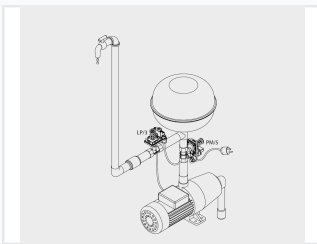

ADDITIONAL IMAGES



Overview

Reliable Low-Pressure Protection

This low-pressure switch is engineered to safeguard water systems, including booster sets and fire-fighting installations, as well as pneumatic control circuits. It effectively interrupts the electrical connection when system pressure drops below a critical threshold, preventing damage from dry running when used in series with standard pressure switches. Designed for versatility, it features both automatic reset capabilities and a manual reset button for flexible operation.

Technical Data

Rated Current

16 A

Rated Current

Protection Degree

IP44

Temperature Limits

- Max fluid temperature: 55°C
- Max ambient temperature: 55°C

Rated Voltage

250 V

Standard Connection

1/4" F

Performance Models

Model Specifications

Model	Cut-out Range	Factory Setting
LP/3	0.05-0.4 bar	0.1-0.45 bar
LP/3-18	0.5-2.0 bar	0.5-0.95 bar

Construction

Materials

Brass alloy contacts, Ag-Ni surfacing, NBR rubber nylon membrane

Dimensions

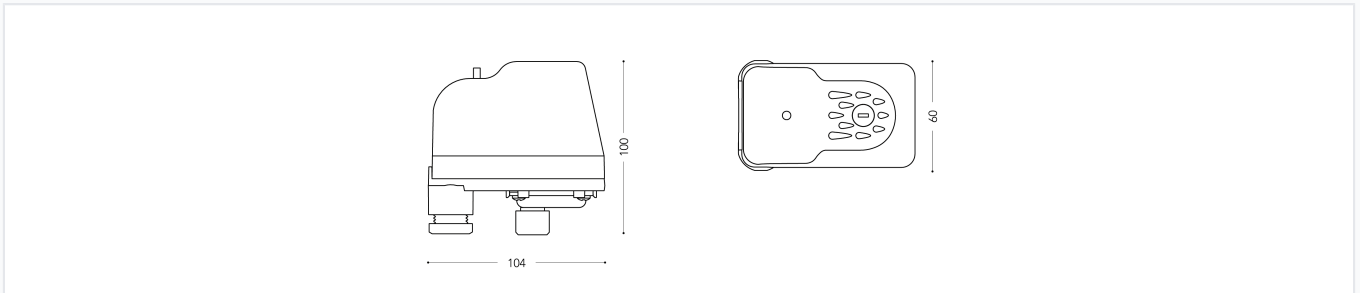

Dimensional drawing for installation planning.

Physical Dimensions

- Length: 104mm
- Height: 100mm
- Width: 60mm