

Library Anti-Theft EM Security Antenna

This EM security antenna is designed for library anti-theft systems. It provides reliable detection of EM security tags, ensuring protection against unauthorized removal of library materials.



ADDITIONAL IMAGES



Overview

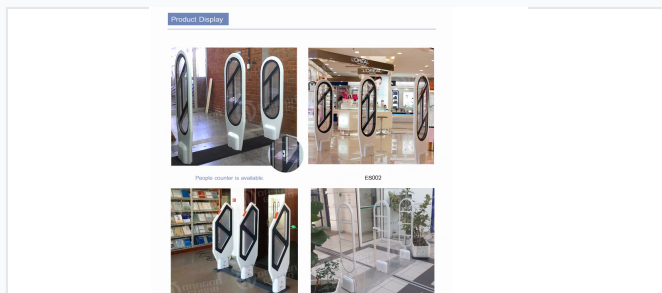

Sleek and modern antenna design suitable for library environments.

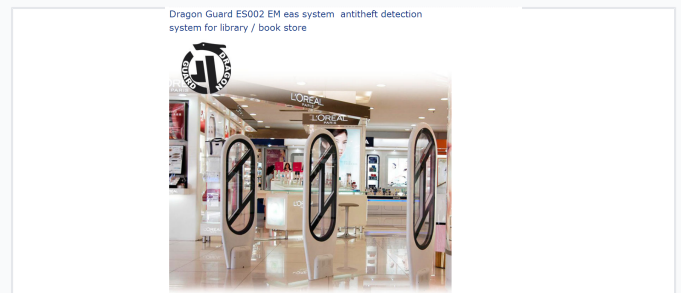

Dragon Guard E5002 EM eas system antitheft detection system for library / book store

Advanced EM Security for Libraries

This high-sensitivity Electromagnetic (EM) security system is specifically designed for retail loss prevention in libraries and bookstores. It offers a reliable anti-theft solution with a sleek design that integrates seamlessly into professional environments. With flexible installation options and advanced signal processing, it ensures maximum detection accuracy while minimizing false alarms.

Technical Specifications



Fully customizable options including logo, color, frame material, and alarm lights.

Technology

EM (Electromagnetic)

Key Features

- High sensitivity detection
- Wide detection distance
- Optional people counter
- Customizable alarm light and frame material
- Adjustable cable length

Model Number

ES002

Materials

Advanced Resin, Glass, MDF

Detection Performance

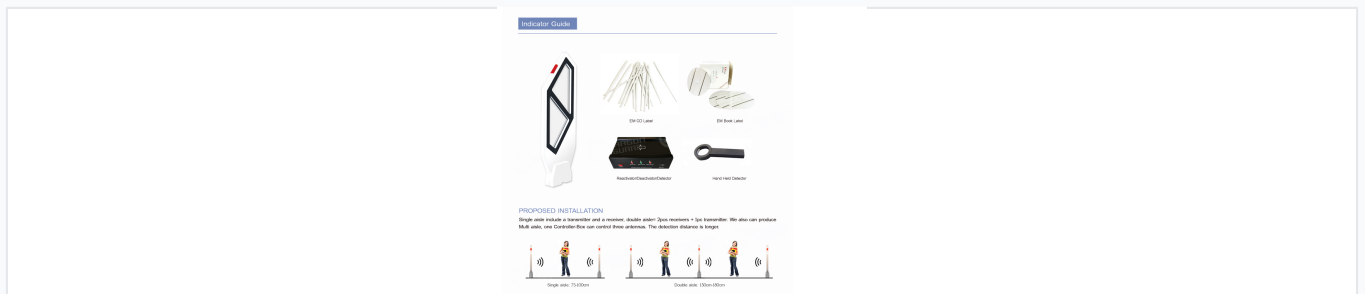

Proposed installation configurations for single, double, and multi-aisle setups.

Detection Range

100 cm

Single Aisle Max

180 cm

Double Aisle Max

Installation Configurations

Setup Type	Components	Detection Distance
Single Aisle	1 Transmitter + 1 Receiver	75 - 100 cm
Double Aisle	1 Transmitter + 2 Receivers	150 - 180 cm
Multi Aisle	1 Controller-Box for 3 Antennas	Extended Range

Compliance & Quality

Certifications

CE, ISO, ROHS, SGS, MSDS

Logistics & Packaging

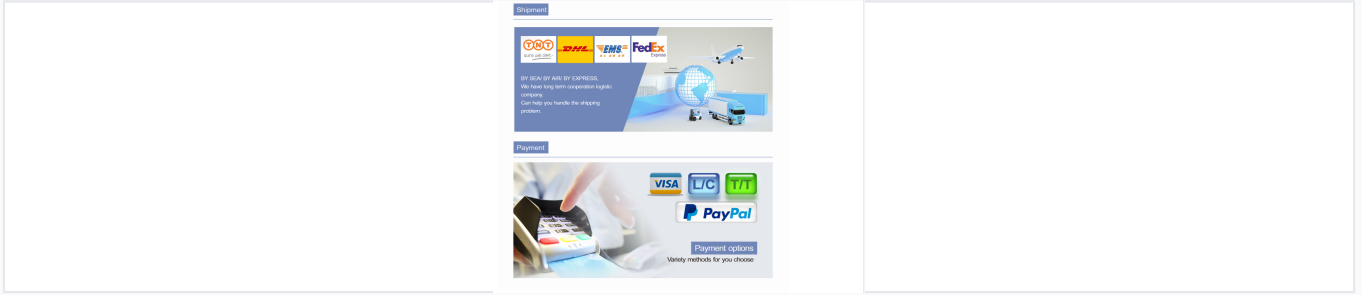

Flexible shipping via sea, air, or express with various payment options.

Packaging Specifications

Component	Weight	Dimensions
Antenna System (1 set/ctn)	36.0 kg	150 x 70 x 30 cm
Controller Box (1 set/ctn)	6.5 kg	43 x 33 x 32 cm

Lead Time

- 1-10 sets: 10 days
- 11-50 sets: 15 days
- Over 50 sets: Negotiable

Supply Ability

100 sets per week