

LED Indicator Signal Light

This LED indicator signal light provides clear signaling for industrial equipment. It features energy-efficient LED technology and a durable construction for long-lasting performance.



Overview

High-Performance LED Signaling

The AD22-22AS series represents a modern advancement in indicator technology, utilizing high-brightness LED chips to replace traditional incandescent and neon lamps. Designed for industrial reliability, these indicators offer a compact, lightweight form factor with significantly lower power consumption and a longer operational lifespan. The robust polycarbonate lens provides superior anti-surge performance and high intensity, making it ideal for demanding environments like power plants, telecommunications, and heavy machinery.

Key Metrics

Performance Highlights

230 V Standard Voltage	20 mA Max Current	2.5 kV Dielectric Strength
----------------------------------	-----------------------------	--------------------------------------

Technical Specifications



Specializing in production of buttons and indicators since 1997

The AD22-22AS features clear technical markings including voltage ratings and compliance standards for easy installation.

Insulation Resistance	eM©
Voltage Wave Allowed	±20%
Working Frequency Voltage	2.5kV (AC valid value), 1min

Physical Dimensions



AD22-22AS

Protected
LED
Indicator

24V AC/DC
36V AC/DC
48V AC/DC
110V AC/DC
127V AC/DC
220V AC/DC

- Red
- Yellow
- Green
- Pure Green
- Pure Blue
- Pure White

AD22-22AS

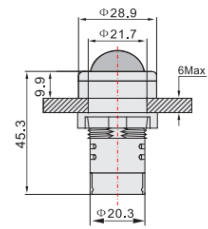

Detailed dimensions and color availability for the AD22-22AS series indicator lights.

Mounting Dimensions

Dimension Type	Measurement
Head Diameter	±28.9mm
Body Diameter	±21.7mm
Installation Diameter	±20.3mm
Total Length	45.3 mm
Height Above Panel	9.9 mm
Max Panel Thickness	6 mm

Configuration Options

Available Colors

Red • Yellow • Green • Pure Green • Pure Blue • Pure White

Supported Voltages (AC/DC)

- 24V
- 36V
- 48V
- 110V
- 127V
- 220V

Applications

Target Industries

Electrical Power, Telecommunications, Machine Tools, Watercraft, Textiles, Printing, Mine Machinery

Compliance

Standards & Certifications

CE, IEC947-5-1, EN60947-5-1

Design Features

Construction Features

- High-intensity polycarbonate lampshade
- Superior anti-surge performance
- Safe and convenient bolt-type connectors
- Compact short-base design (S-type)
- Available in double-color and buzzer variants