

# Inner Wall Cylinder Brush

This cylinder brush is designed for painting inner walls. It features a 230mm (9") roller and is suitable for middle-density surfaces.

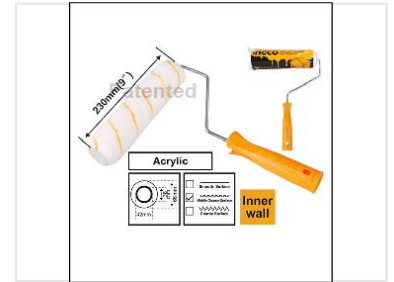

## Product Overview

### Professional Inner Wall Cylinder Brush

This high-quality cylinder brush is specifically engineered for efficient inner wall painting applications. Featuring a 230mm (9-inch) roller width, it is optimized for consistent coverage on middle-dense surfaces. The design includes a robust 6mm central shank, ensuring stability and ease of use for professional painting tasks.

## Technical Specifications

### Roller Size

**230 mm**  
Width

**9 in**  
Width

### Fibre Height

12 mm

### Central Shank Diameter

6 mm

## Application Details

### Material Type

Acrylic

### Suitable Surfaces

Inner Wall, Middle Dense Surfaces