

Electronic Pump Controller with Protection Features

This electronic device is designed to control and protect water pumps. It manages the start and stop of the pump, ensuring constant pressure and flow rate while also protecting against dry running and overcurrent.

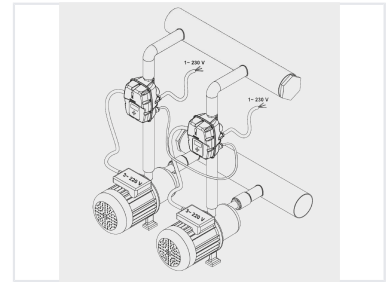

ADDITIONAL IMAGES



Product Overview

Smart Pump Control

This advanced electronic controller manages electric pump operations by modulating motor speed based on real-time water demand, ensuring constant system pressure. By regulating soft starts and stops, it effectively eliminates water hammering and avoids high inrush starting currents. The unit is designed to safeguard infrastructure with comprehensive protection against dry running, leaks, over-pressure, and electrical abnormalities.

Technical Performance

Operational Metrics

230 V

Voltage

12 A

Max Current

8 bar

Max Pressure

IP Protection

IP X5

Frequency Range

50/60 Hz

System Compatibility

Control & Connectivity

- Wi-Fi smartphone connectivity
- Programmable I/O for Master/Slave configuration
- Multilingual 16-character display
- Adjustable flow sensor sensitivity

Compatible Pump Types

Surface, Vertical, Submersible

Physical Dimensions

Unit Dimensions

Dimension	Value
Length	254
Width	147
Height	143

Safety & Protection

Automated Protections

- Dry running protection with auto-reset
- Leakage detection
- Over-pressure protection
- Over-heating protection
- Rotor blocking detection
- Abnormal power supply monitoring
- Motor over-current control