

DC Motor for Central Locking Systems

This DC motor is engineered for central locking systems in vehicles. It provides efficient and reliable actuation for automotive security applications.

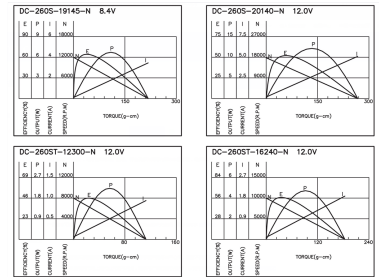

ADDITIONAL IMAGES

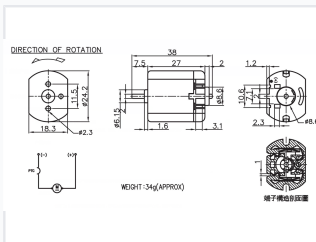

Overview

High-Efficiency Central Locking Actuator Motor

This compact carbon-brush DC motor is engineered specifically for automotive central locking systems and security applications. Featuring a robust metal housing and durable plastic end cap, it ensures reliable actuation and long-term performance. The design includes an integrated PTC thermistor for essential overload protection, making it a safe and efficient choice for demanding automotive environments.

Physical Dimensions

| | |
|--------------------|---------|
| Motor Length | 38 mm |
| Motor Diameter | 24.2 mm |
| Shaft Diameter | 6.15 mm |
| Approximate Weight | 34 g |

Mounting & Connectivity

| | |
|------------------------|---------|
| Mounting Hole Diameter | 2.3 mm |
| Mounting Hole Spacing | 18.3 mm |
| Terminal Spacing | 2.3 mm |

Technical Features

| | |
|---------------------|-------------------------------------|
| Protection Features | PTC Thermistor, Overload Protection |
| Motor Type | Carbon-brush DC motor |

Performance Data

Available Motor Models

| Model | Voltage |
|------------------|---------|
| DC-260S-19145-N | 8.4V |
| DC-260S-20140-N | 12.0V |
| DC-260ST-12300-N | 12.0V |
| DC-260ST-16240-N | 12.0V |