

Central Locking DC Motor

This DC motor is designed for central locking systems in vehicles. It provides the rotational force necessary for locking and unlocking mechanisms.

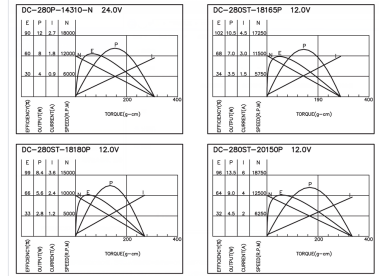

ADDITIONAL IMAGES

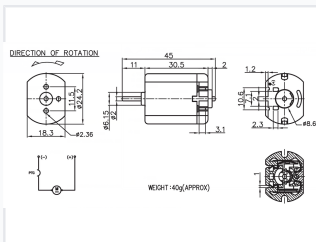

Overview

Compact DC Motor for Locking Systems

This compact DC motor is engineered specifically for central locking mechanisms in automotive and security applications. Featuring a durable metal housing and a robust steel shaft, it ensures reliable rotational power for locking and unlocking operations. The design includes integrated overcurrent protection via an onboard PTC thermistor for enhanced safety and longevity.

Common Applications

Automotive Central Locking, Security Systems, Access Control

Physical Specifications

Construction Features

Metal Housing • Plastic End Cap • Steel Shaft • PTC Protection

Motor Body Length	45 mm
Shaft Diameter	2 mm
Approximate Weight	40 g
Mounting Hole Diameter	2.36 mm

Performance Data

Model Performance Comparison

Model	Voltage	Max Speed (RPM)
DC-280P-14310-N	24.0V	18000
DC-280ST-18165P	12.0V	17250
DC-280ST-18180P	12.0V	15000
DC-280ST-20150P	12.0V	18750