

# Air Disc Brake Caliper with Bendix 12-Degree Configuration

This air disc brake caliper is designed for heavy-duty applications. It features a 12-degree Bendix caliper configuration for optimal braking performance.



## ADDITIONAL IMAGES



## Overview



High-performance air disc brake caliper featuring 12-degree Bendix-style configuration.

### High-Performance Air Disc Brake Caliper

This air disc brake caliper is engineered for heavy-duty applications, featuring a 12-degree Bendix-style configuration for superior braking performance. It is a completely new unit, manufactured with precision using automatic assembly and testing lines to ensure 100% reliability. Designed for durability in demanding conditions, it is an ideal replacement or upgrade for commercial vehicles.

## Technical Specifications

**Certification**  
IATF 16949

**OEM Number** K081142

**Caliper Configuration** 12-Degree Bendix Style

**Condition** New

## Application

**Compatible Vehicles** Heavy Duty Truck, Bus, Trailer

## Logistics

### PACKAGING&SHIPPING



Standardized neutral packaging options including pallets and cartons for global distribution.

### Packaging Options

- Neutral packaging
- Plastic bag
- Box
- Carton
- Pallet
- Customized packaging

## Assembly Details

### APPLICATIONS

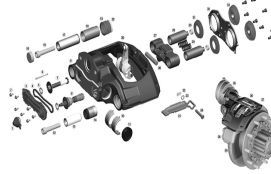

1 Adjuster Cap	11 Bleed Pin	21 Piston Pin	31 Secondary Pad
2 Outer Guide Bolt	12 Short Guide Sleeve Bolt	22 Piston Pin O-Ring	32 Outer Pin
3 Outer Cover	13 Short Guide Sleeve	23 Piston Return Spring	33 Spring Shim Assembly
4 Cover	14 Short Guide Sleeve Nutting	24 Piston Pin	34 Outer Pin Bolt
5 Shim Wash	15 Long Guide Sleeve O-Ring	25 O-Ring Seal	35 Inboard Pin
6 Bleed Valve/Primary Pin	16 Long Guide Sleeve Bolt	26 Lower Pin	36 Inboard Nut
7 Secondary Guide Assembly	17 Long Guide Sleeve	27 Adjuster Shim	37 Adjuster Pin
8 Shim/Adjuster Assembly	18 Bleed Spring	28 Spring	38 Cover
9 Housing	19 Guide Sleeve Bolt	29 Piston Spring	39 Brake Disc
10 Wash Shim	20 Guide Sleeve Bolt Nut	30 Wash Shim	40 Inboard Shim

Detailed component breakdown of the caliper assembly, including adjustment, actuation, and guide systems.

### Key Components

Component Category	Included Parts
Adjustment System	Adjuster cap, Primary/Secondary adjuster assembly
Housing & Guides	Housing, Long/Short guide sleeves, Needle bearing
Actuation	Lever assembly, Piston, Return spring, Tappet assembly
Wear Indicators	Pad wear warning indicator pin