

Agricultural Water Pump for Irrigation

This robust water pump is designed for agricultural applications such as irrigation and drainage. Its durable cast metal construction and optimized impeller ensure efficient, high-volume water displacement.

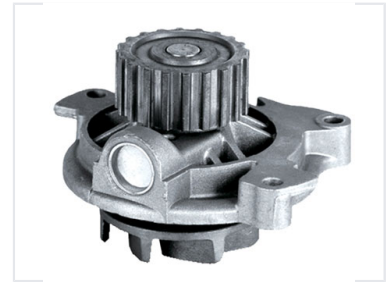

Overview

High-Efficiency Agricultural Water Pump

This robust water pump is specifically engineered for high-volume agricultural irrigation and drainage tasks. Constructed from durable cast metal, it is built to withstand demanding operating conditions while ensuring long-lasting performance. With an optimized impeller design and reliable belt-driven power transmission, this pump offers a cost-effective and low-maintenance solution for efficient water management.

Technical Specifications

Construction Material	Cast Metal
Drive Mechanism	Belt-driven with toothed pulley
Installation Features	Multiple mounting points, Flexible configuration

Performance

Primary Applications

Agricultural Irrigation • Water Drainage

Operational Benefits

- High-volume water displacement
- Durable construction
- Minimal maintenance requirements
- Reliable power transmission