

8.2 MHz RF Security Alarm Antennas for Retail

This 8.2 MHz RF security system uses antennas to detect tagged merchandise. It is designed for installation at store entrances and exits to monitor the flow of merchandise and prevent theft.



ADDITIONAL IMAGES



Overview



Durable ABS and metal construction featuring a clear visual alarm light and stable base.

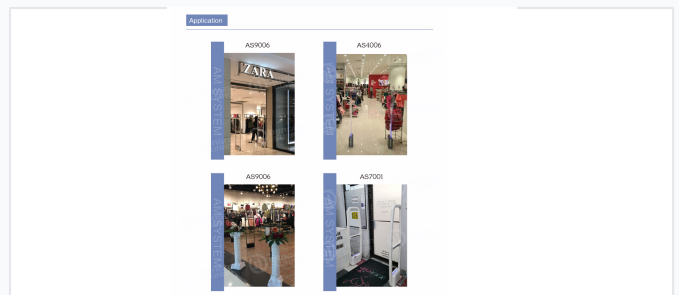

Ideal for clothing shops and high-traffic retail environments to prevent inventory loss.

Professional Retail Loss Prevention

This 8.2 MHz RF security antenna system provides a robust anti-theft solution for modern retail environments, including clothing shops, supermarkets, and digital stores. Designed for high-performance detection, the system features advanced software control to maintain stability even in electronically noisy environments. Its durable ABS and metal construction, combined with a visual warning light, ensures both reliable security and a clear deterrent for shoplifting.

Technical Specifications

Operating Frequency

8.2 MHz
Frequency

Unit Dimensions

170 x 49 x 11 cm

Construction Material

ABS, Metal

Performance & Features

Clothing Shop 8.2 Mhz Security Alarm RF Detection Antennas System



Product Specification

- Easy installation, high performance
- Wide detection range
- Advanced technology with software control which reduces antennas
- Works stable even in the retail environment.

High-performance RF detection system designed for stable operation in retail environments.

System Advantages

- Easy installation
- High performance detection
- Wide detection range
- Advanced software control
- Stable operation in noisy environments
- Integrated visual warning light
- Firm and safe base design

Compatibility



Comprehensive range of compatible RF labels, hard tags, and deactivation tools.

Compatible RF Accessories

- RF Labels
- Hard Tags with pins
- Stoplocks
- Safer containers
- RF Deactivators
- Magnetic Detachers

Customization Options

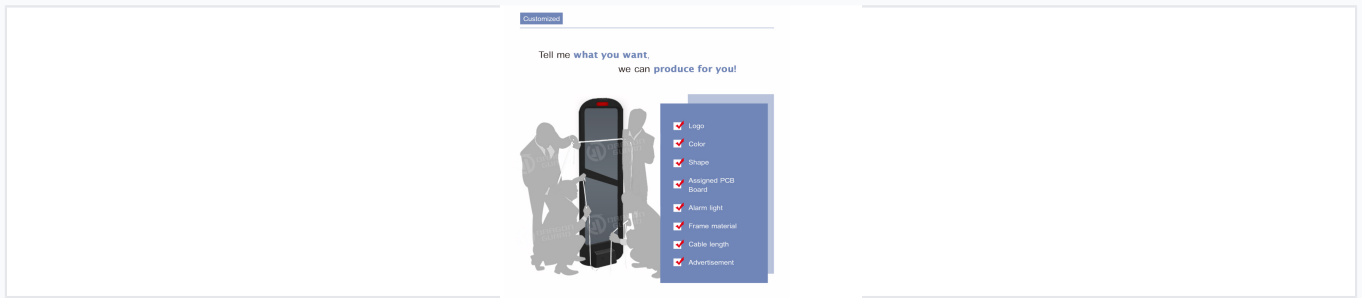

Flexible customization including logo, color, and hardware configurations to match store branding.

Available Customizations

Logo • Color • Shape • PCB Board • Alarm Light • Frame Material • Cable Length • Advertisement Panels

Logistics & Supply

Packaging & Shipping

Parameter	Details
Packaging	1pc/ctn
Carton Weight	24.0 kgs
Carton Dimensions	165 x 45 x 15 cm
Port of Shipment	Shanghai
Supply Ability	5000 Sets per Week

Lead Time

Quantity (Sets)	Est. Time (Days)
1-10	10
11-50	15
50+	0

Compliance

Quality Certifications	CE, ISO, ROHS, SGS, MSDS
------------------------	--------------------------