

# 20 kW Diesel Generator for Telecom Applications

This 20 kW diesel generator is engineered for telecom applications. It provides a reliable and efficient power supply for telecommunications infrastructure.



## ADDITIONAL IMAGES



## Product Overview

### Reliable Telecom Power Solution

This 20 kW diesel generator is specifically engineered to provide stable and continuous power for critical telecommunications infrastructure. Designed for durability and efficiency, it features a robust construction suitable for diverse environmental conditions. With advanced control systems and a high-capacity fuel tank, this unit ensures reliable operation for both backup and primary power requirements.

## Performance Metrics

Genset Model		GENSET SPECIFICATION					ENGINE SPECIFICATION				ALTERNATOR MODEL
		KVA		CONS 100% (L/H)	DB(A) @7M	TANK (L)	PERKINS ENGINE MODEL	CYL.	GOV.	ASP.	
		ESP	PRP								
KPX-P20P		22	20	6.2	66	1000	404D-22G	4	M	NA	LSAVSDC423S5
KPX-P20PVS		22	20	6.2	66	1000	404D-22	4	E	NA	LSAVSDC423S5

Performance data overview including power ratings, fuel consumption, and noise levels.

### Power Output

**20 kW**

Prime Power

**22 kVA**

Standby Power

### Operational Specifications

Parameter	Value
Fuel Consumption (100% Load)	6.2 L/h
Noise Level (@ 7m)	66 dB(A)
Fuel Tank Capacity	1000 L
Engine Cylinders	4

## Features & Compliance

#### Enclosure Options

- Open type
- Silent type
- Super silent type

#### Certifications

ISO Certified, CE Certified

## Technical Design

Generator Drawing

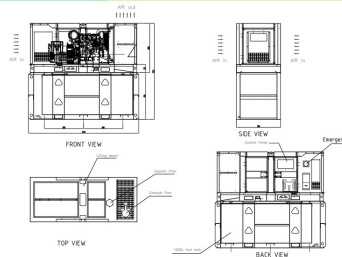

Comprehensive technical layout showing air intake, exhaust, control panel, and fuel tank positioning.

#### Daily Maintenance Checklist

- Check fuel level
- Check oil level
- Check water level
- Inspect battery cables
- Check for leaks
- Inspect exhaust system