

Submersible Sewage Water Pump, 0.75-1.5kW

This submersible sewage pump is designed with a channel impeller to prevent clogging from solids. It is suitable for wastewater discharge in industrial, commercial, and residential applications.



Overview

High-Efficiency Submersible Sewage Pump

The B Series is a robust submersible sewage pump featuring a specialized channel impeller designed to prevent internal clogging by solids. Engineered for demanding environments, it handles wastewater, muddy water, and lye across industrial, municipal, and agricultural applications. With a durable cast iron construction and AISI304SS stainless steel shaft, this pump ensures reliable performance in both single and three-phase power configurations.

Key Performance Metrics

Performance Highlights

860 m³/h

Max Capacity

44 m

Max Head

20 m

Immersion Depth

1.5 kW

Max Power

Technical Specifications

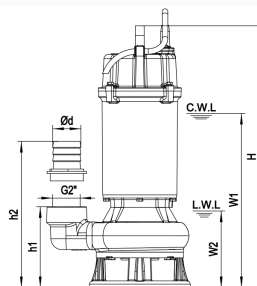

Standardized dimensions and water level requirements for installation planning.

Insulation Class

Class F

Protection Rating

IP68

Operating Limits

- Water temperature: up to 40
- PH Range: 6 - 10
- Liquid Density: 1.3g/cm³
- Cable length: 8m

Materials of Construction

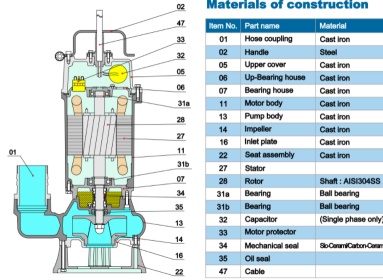

Materials of construction

Item No.	Part Name	Material
01	Hose coupling	Cast Iron
02	Handle	Steel
05	Upper cover	Cast Iron
06	Up-Bearing house	Cast Iron
07	Bearing house	Cast Iron
11	Motor body	Cast Iron
13	Pump body	Cast Iron
14	Impeller	Cast Iron
16	Inlet plate	Cast Iron
22	Seat assembly	Cast Iron
27	Stator	
28	Rotor	Shaft: AISI304SS
31a	Bearing	Ball bearing
31b	Bearing	Ball bearing
32	Capacitor	(Single phase only)
33	Motor protector	
34	Mechanical seal	SiO-Ceramic/Carbon-Ceramic
35	Oil seal	
47	Cable	

Detailed internal construction showing cast iron components and stainless steel shaft for maximum durability.

Component Materials

Component	Material
Pump Body & Impeller	Cast Iron
Motor Body & Upper Cover	Cast Iron
Rotor Shaft	AISI304SS Stainless Steel
Mechanical Seal	SiO-Ceramic / Carbon-Ceramic
Handle	Steel

Applications

Primary Applications

Industrial Wastewater, Municipal Sewage, Storm-water Drainage, Construction Dewatering, Aquaculture, Treatment Plants

Model Comparison

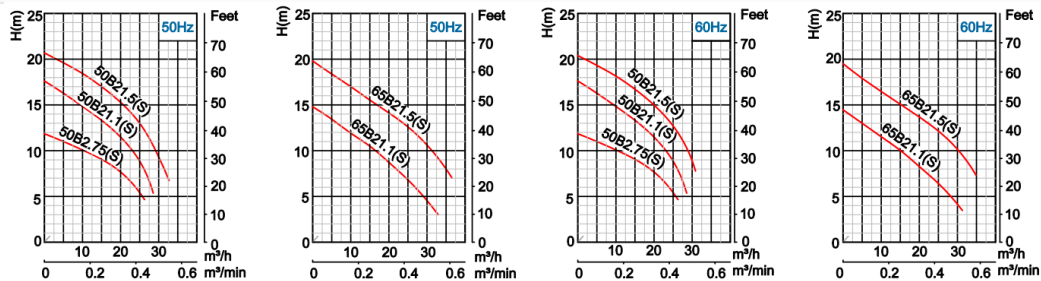

Head vs. Flow rate performance curves for various models in the B Series range.

Performance by Model (50Hz/60Hz)

Model	Power (kW)	Outlet (mm)	Rated Head (m)	Max Flow (m ³ /h)
50B2.75(S)	0.75	50	10	26
50B21.1(S)	1.1	50	15	29
65B21.1(S)	1.1	65	10	33
50B21.5(S)	1.5	50	19	33
65B21.5(S)	1.5	65	15	37