

Pillow Block Ball Bearing Unit

This ball bearing unit has a pillow block housing, which allows for simple mounting. Its pre-lubricated and sealed bearing insert ensures a long service life.

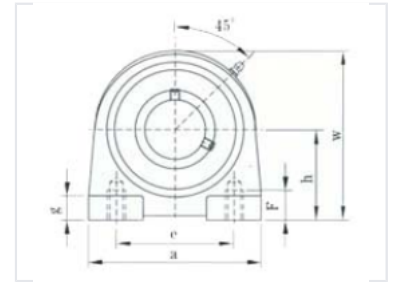

Overview

UCPA200 Series Pillow Block Bearing Unit

The UCPA200 series ball bearing unit is engineered for reliable performance in demanding industrial environments. Featuring a robust cast iron pillow block housing, this unit offers excellent vibration resistance and durability. It comes pre-lubricated and sealed to prevent contamination, ensuring a long service life and reduced maintenance requirements. The design includes a set screw locking mechanism for secure shaft fixation and a convenient 45-degree grease fitting for easy relubrication.

Technical Specifications

| | |
|----------------------|--|
| Housing Material | Cast Iron |
| Locking Mechanism | Set Screw |
| Maintenance Features | Pre-lubricated, Sealed, 45-degree grease fitting |

Key Dimensions

Dimensional Parameters

- Housing Width (W)
- Height (h)
- Base Length (a)
- Mounting Hole Distance (e)
- Bolt Hole Diameter (d)