

Mushroom Head Emergency Stop Push Button Switch with Turn-to-Release

This mushroom head emergency stop push button switch is designed with a turn-to-release mechanism. It is suitable for use in controlling circuits of AC voltage up to 660V/AC50Hz or 60Hz, and DC voltage below 400V.



Product Overview

Industrial Emergency Stop Solution

This mushroom-head emergency stop switch is engineered for safety-critical industrial applications, featuring a reliable turn-to-release mechanism for immediate manual reset. Built with high-grade zinc alloy and anti-flame materials, it ensures durability and consistent performance in demanding environments. The switch is compliant with international safety standards, making it an ideal choice for machine control and emergency shutdown systems.

Electrical Ratings

Rated Insulation Voltage

600 V

Insulation Voltage

Conventional Thermal Current

10 A

Compatibility

AC up to 660V, DC below 400V

Environmental & Durability

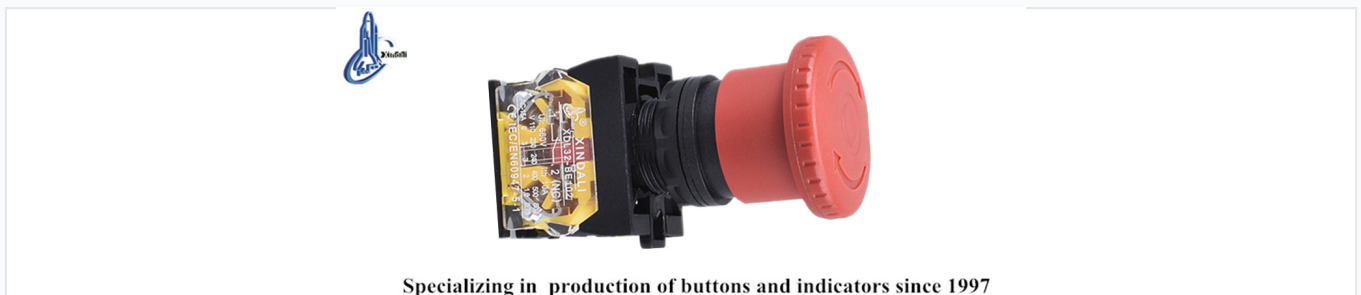

Specializing in production of buttons and indicators since 1997

Robust construction ensures reliable operation in emergency situations.

Protection Grade

IP65 • IP66 • IP67 • IP68

Mechanical Life

300000 ops

Emergency Stop Cycles

Operating Temperature Range

-5°C to +55°C

Technical Specifications



XDL32-ES545

Emergency stop
Turn to release
IP65

N/O+N/C

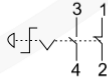

Red $\Phi 40$ XDL32-ES545

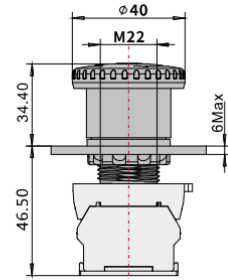

Dimensional specifications showing the M22 mounting diameter and mushroom head profile.

Standards Compliance

- IEC 60947-5-1
- GB/T 14048.1
- GB 14048.5
- CE Certified
- UL Certified

Mounting Details

Parameter	Value
Mounting Hole Diameter	M22
Actuator Diameter	40mm
Fastening Torque	0.8Nm (Max 1.2Nm)