

Mini LED Indicator Light with Red Lamp

This mini LED indicator light features a red lamp for clear signaling. It is designed for use in control panels, machinery, and other industrial equipment.



Overview



High-Performance LED Signaling

The AD22-16DS series represents a modern advancement in indicator technology, utilizing high-brightness LED chips as a long-lasting and low-consumption alternative to traditional incandescent and neon lamps. These compact indicators are designed for high reliability and aesthetic appeal, featuring a durable polycarbonate lampshade with superior anti-surge performance. Engineered for versatility, they are ideal for signaling, forewarning, and accident indication across electrical power, telecommunications, and industrial machinery sectors.

Technical Specifications

| | |
|------------------------------|---|
| Voltage of Working Frequency | 2.5kV (AC valid value), 1min |
| Insulated Resistance | eMI© |
| Voltage Wave Allowed | ±20% |
| Rated Current | 20 mA |
| Compliance Standards | IEC947-6-1, EN50947-5-1, IEC/EN 60947-5-1 |



Physical Dimensions



AD22-16DS

Protected
LED
Indicator

24V AC/DC
36V AC/DC
48V AC/DC
110V AC
127V AC
220V AC

-  Red
-  Green/PG
-  Yellow
-  Pure Blue
-  White/PW

AD22-16DS

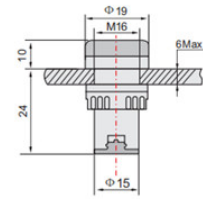

Mounting Specifications

19 mm

Mounting Hole (I)

16 M

Thread Size

6 mm

Max Panel Thickness

24 mm

Total Length

Options & Variants

Available Colors

Red • Green • Yellow • Pure Blue • White

Voltage Options

- 24V AC/DC
- 36V AC/DC
- 48V AC/DC
- 110V AC
- 127V AC
- 220V AC
- 230V AC

Application Areas

Target Industries

Electrical Power, Telecommunication, Machine Tools, Watercraft, Textile, Printing, Mine Machinery

Product Features

Key Benefits

- Long operational life
- Low power consumption
- Small volume and light weight
- High brightness LED source
- Anti-surge polycarbonate lens
- Safe bolt-type connectors