

IP66 Waterproof DC Isolator Switch 10A 16A 20A 25A 32A

This IP66 DC isolator switch is designed to isolate direct current electrical circuits, withstanding harsh conditions. Its IP66 rating ensures it is dust-tight and protected against high-pressure water jets, typically used in outdoor solar panel systems and EV charging.

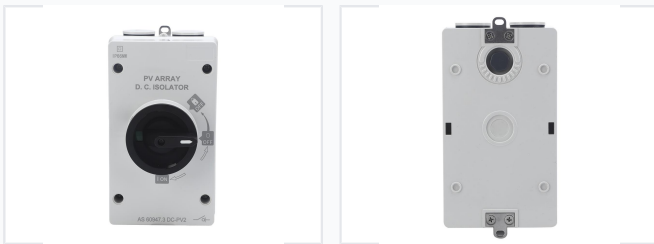

ADDITIONAL IMAGES



Product Overview

Robust DC Isolation

This IP66-rated DC isolator switch is engineered for reliable circuit disconnection in solar photovoltaic (PV) and AC/DC systems. Designed to withstand harsh outdoor environments, it provides superior protection against dust and high-pressure water jets. The unit features a durable, flame-retardant construction and is built for long-term operational safety during maintenance or emergency shutdowns.

Technical Specifications

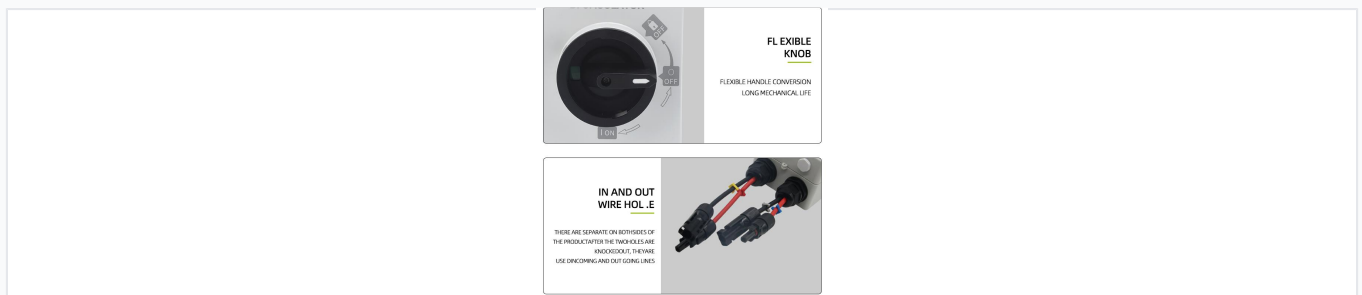

Ergonomic handle design with flexible wiring options for secure installation.

Ingress Protection Rating

IP66 (Enclosure) • IP20 (Switch Body)

Rated Operational Voltage

500V, 600V, 800V, 1000V, 1200V

Rated Current Options

10A, 16A, 20A, 25A, 32A

Number of DC Poles

2 or 4

Polarity

No Polarity

Performance & Durability



Weatherproof construction featuring UV and chemical resistance for outdoor longevity.



Constructed with high-grade flame-retardant PC material for enhanced heat and wear resistance.

Mechanical Life Cycle	15000
Electrical Life Cycle	1000
Operating Temperature	-40°C to +85°C

Compliance

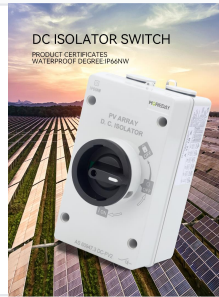

Certified IP66-rated enclosure designed for reliable solar PV array isolation.

Standards Compliance	
<ul style="list-style-type: none"> • IEC60947-3 • AS60947.3 	
Certifications	TUV, CE, CB, CCC