

# High-Security Cam Lock

This high-security cam lock is designed for robust security applications. Constructed from durable materials, it features a rotating cam mechanism for secure locking.



## ADDITIONAL IMAGES



## Overview

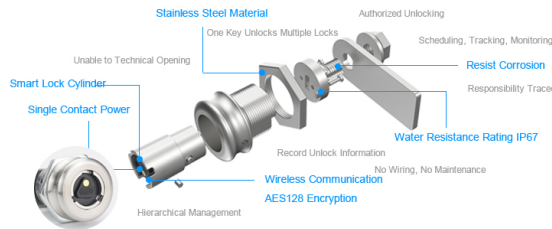

Key benefits including IP67 water resistance, AES128 encryption, and audit trail capabilities.

## High-Security Electronic Cam Lock

This high-security cam lock system provides a robust access control solution for cabinets, drawers, and enclosures. Utilizing a smart electronic key and cylinder, it eliminates the need for traditional keys while offering advanced features like audit trails, scheduling, and hierarchical management. The system is designed for durability and security, featuring AES128 encryption and water-resistant construction suitable for diverse environments.

## Key Features

### Core Features

AES128 Encryption, Audit Trail Logging, Water Resistant (IP67), No Wiring Required, Hierarchical Management, Anti-Tamper Design

## Technical Specifications

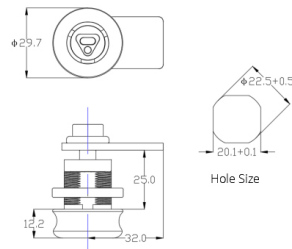

Dimensional drawing showing the cylindrical body diameter and mounting hole specifications.

### Physical Dimensions

Component	Measurement
Body Diameter	29.7 mm
Hole Size Diameter	22.5 mm
Total Assembly Height	25.0 mm
Bottom Diameter	32.0 mm
Bottom Height	12.2 mm

### Environmental Ratings

**67 IP**

Water Resistance Rating

**70 °C**

Max Operating Temperature

**-20 °C**

Min Operating Temperature

## Smart Key Capabilities



Comparison of different electronic key models and their specific technical capabilities.

### Smart Key Capabilities

- Unique 64-bit ID identification code
- Two-way verification authentication
- Voice prompt status updates
- Bluetooth communication options
- Fingerprint authentication models available
- Real-time unlock data upload

### Electronic Key Performance

Metric	Value
Battery Capacity	600 mAh
Unlocks per Charge	1000
Charging Time	2 hours
Storage Capacity	60,000 records
Service Life	10 years