

# DC Motor for Automotive Water Pumps

This DC motor is designed for automotive water pump applications. It features efficient power consumption and reliable operation.

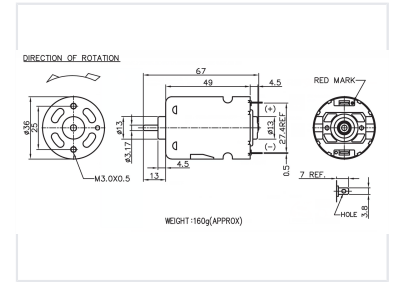

## ADDITIONAL IMAGES

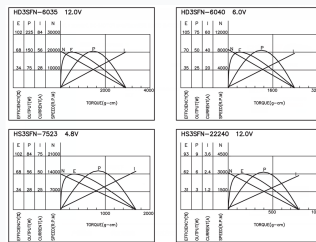

## Overview

### High-Performance Automotive DC Motor

This high-performance DC motor is precision-engineered for automotive water pump applications, offering a compact and robust solution for demanding pumping systems. Designed for durability and efficient power consumption, it ensures reliable operation in various environmental conditions. With versatile mounting options and clear polarity markings, this motor is built for seamless integration into professional automotive cooling and fluid circulation assemblies.

## Physical Dimensions

### Outer Diameter

- 36
- 25

Overall Length	67 mm
Body Length	49 mm
Shaft Diameter	3.17 mm
Approximate Weight	160 g

## Mounting and Installation

Mounting Holes	M3.0x0.5
Terminal Features	Positive Polarity (+), Negative Polarity (-), Red Mark Indicator

## Performance Metrics

### Available Motor Models

Model	Voltage
HD3SFN-6035	12.0V
HD3SFN-6040	6.0V
HS3SFN-7523	4.8V
HS3SFN-22240	12.0V