

Air Disc Brake Caliper with Bendix 12-Degree Configuration

This air disc brake caliper is designed for heavy-duty applications. It features a 12-degree Bendix caliper configuration for optimal braking performance.



ADDITIONAL IMAGES



Overview



High-performance air disc brake caliper featuring 12-degree Bendix-style configuration.

High-Performance Air Disc Brake Caliper

This air disc brake caliper is engineered for heavy-duty applications, featuring a 12-degree Bendix-style configuration for superior braking performance. It is a completely new unit, manufactured with precision using automatic assembly and testing lines to ensure 100% reliability. Designed for durability in demanding conditions, it is an ideal replacement or upgrade for commercial vehicles.

Technical Specifications

Certification
IATF 16949

OEM Number K081142

Caliper Configuration 12-Degree Bendix Style

Condition New

Application

Compatible Vehicles Heavy Duty Truck, Bus, Trailer

Logistics

PACKAGING&SHIPPING



Standardized neutral packaging options including pallets and cartons for global distribution.

Packaging Options

- Neutral packaging
- Plastic bag
- Box
- Carton
- Pallet
- Customized packaging

Assembly Details

APPLICATIONS

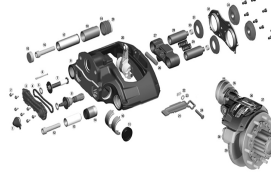

1 Adjuster Cap	11 Bleed Pin	21 Piston Pin	31 Bleed Pin
2 Outer Guide Bolt	12 Short Guide Sleeve Bolt	22 Piston Pin O-Ring	32 Outer Pin
3 Outer Guide	13 Short Guide Sleeve	23 Piston Return Spring	33 Spring Retainer
4 Outer	14 Short Guide Sleeve Nut	24 Piston Pin	34 Outer Pin Bolt
5 Spring	15 Long Guide Sleeve O-Ring	25 O-Ring	35 O-Ring
6 Bleed Valve/Adjuster Pin	16 Long Guide Sleeve Bolt	26 Lower Pin	36 Inner Pin
7 Secondary Guide Assembly	17 Long Guide Sleeve	27 Adjuster Pin	37 Guide Pin
8 Secondary Guide Assembly	18 Bleed Spring	28 O-Ring	38 Center
9 Housing	19 Guide Sleeve Bolt	29 Piston Spring	39 Bleed Pin
10 Washers	20 Guide Sleeve Nut	30 Washers	40 O-Ring

Detailed component breakdown of the caliper assembly, including adjustment, actuation, and guide systems.

Key Components

Component Category	Included Parts
Adjustment System	Adjuster cap, Primary/Secondary adjuster assembly
Housing & Guides	Housing, Long/Short guide sleeves, Needle bearing
Actuation	Lever assembly, Piston, Return spring, Tappet assembly
Wear Indicators	Pad wear warning indicator pin