

## 72V Electric Motorcycle for Adults

This electric motorcycle is designed for adult riders and powered by a 72V lithium battery. The e-scooter provides efficient electric performance for urban commuting and leisure rides.



### ADDITIONAL IMAGES



### Overview



Clear digital interface providing essential riding metrics and status updates.

### High-Performance Electric Motorcycle

This adult electric motorcycle is engineered for urban commuting and recreational riding, combining sleek aesthetics with modern electric powertrain technology. It features a robust steel frame, advanced hydraulic suspension, and a powerful dual-mode motor system that delivers responsive acceleration. Designed for comfort and efficiency, it offers a smooth, quiet, and eco-friendly transportation experience.

## Performance

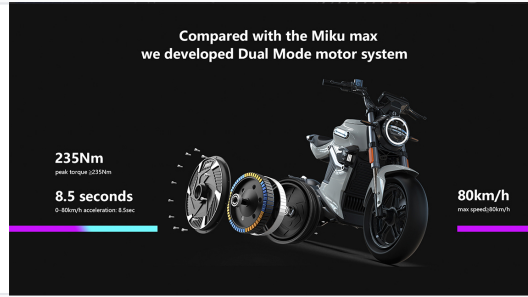

The dual-mode motor system is engineered for high torque and rapid acceleration.

Top Speed	80 km/h
Range per Charge	135 km
0-80km/h Acceleration	8.5 s
Climbing Ability	27 °
Peak Torque	235 Nm

## Battery & Motor

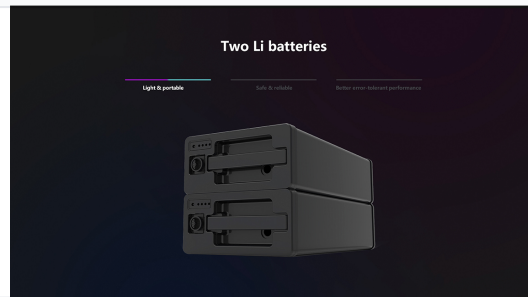

Portable dual lithium battery system designed for reliability and easy charging.

Motor Power	3000 W
Battery Configuration	72V, Lithium-ion, Dual Battery, Portable
Charging Time	4 hours

## Dimensions & Build

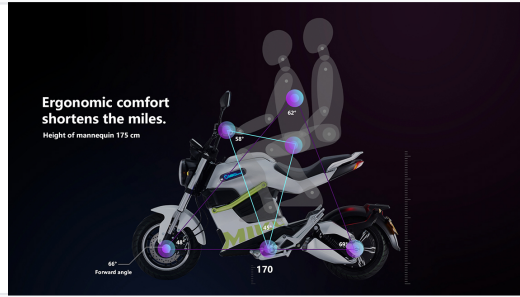

Optimized ergonomic design ensures comfort for riders of various heights.

## Vehicle Dimensions

Dimension	Value	Unit
Length	1850	mm
Height	1040	mm
Width	745	mm

## Frame Material

High-strength steel

## Features

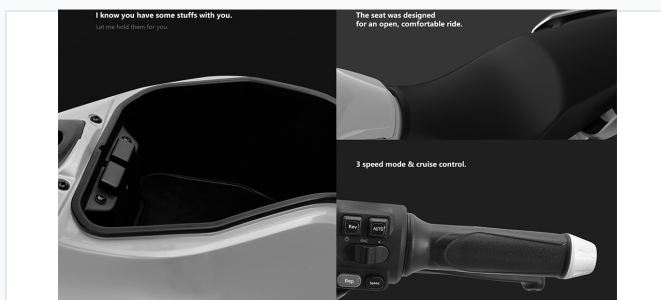

Intuitive handlebar controls for speed adjustment, cruise control, and reverse functionality.



Advanced braking system for enhanced safety and confident stopping power.

## Riding Features

- 3-Speed Mode
- Cruise Control
- Reverse Mode
- Automatic Mode

## Braking & Suspension

Front Hydraulic Shock • Rear Hydraulic Shock • Front Disc Brake • Rear Disc Brake • CBS Braking System

## Certifications

EEC Approved 168/2013, Waterproof Standard (320mm)