

# 130mm Series Brushless DC Gear Motor

This brushless DC gear motor features high power density, a small moment of inertia, and quick reaction. It is suitable for high-performance motion control applications, including CNC machines, industrial controls, and home appliances.



## Overview

### High-Performance 130mm Brushless DC Motor

The 130mm Series Brushless DC Gear Motor is engineered for high power density and long-term reliability in demanding industrial environments. It features a permanent magnet construction that provides high efficiency, low noise, and spark-free operation compared to traditional brushed motors. Designed for versatile motion control, it supports various protection functions including overvoltage and overheating safeguards, making it ideal for CNC machinery, electric vehicles, and home appliances.

## Key Performance Metrics

### Performance Highlights

**3000 RPM**

Rated Speed

**785 W**

Rated Power

**2.5 N·m**

Rated Torque

## Technical Specifications

### Model Specifications

Model Number	Poles	Voltage (VDC)	Power (W)	Torque (N·m)	Length (mm)	Weight (Kg)
130-BLB0D062204RN-01	8	48	785	2.5	120	5
130-BLB0J125404RN-01	8	310	1570	5	155	7

## Physical Characteristics

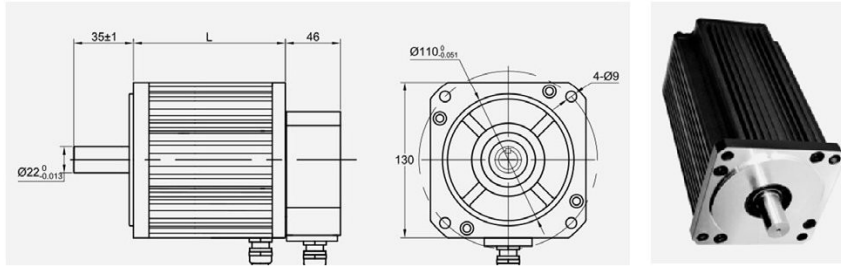

Detailed engineering drawing showing mounting dimensions, shaft diameter (22mm), and frame size for the 130mm series.

<b>Construction</b>	Permanent Magnet
<b>Commutation</b>	Brushless
<b>Shaft Diameter</b>	22 mm
<b>Mounting Flange Size</b>	130 mm

## Operational Standards

<b>Protection Class</b> IP40 • IP65 Optional • Waterproof	
<b>Work Duty</b> <ul style="list-style-type: none"><li>• S1 (Continuous)</li><li>• S2</li><li>• S3</li></ul>	
<b>Insulation Class</b>	Class B, Class F

## Applications

<b>Target Applications</b>	CNC Machine Tools, Electric Bicycle, Industrial Control, Home Appliances, Boat, Car
----------------------------	---

## Certifications

<b>Compliance</b> CCC • CE	
-------------------------------	--